

# Carbon Steel Ball Valve - Flanged PN16 - Full Bore

LV8830

Flanged PN16, Welded A105 Carbon Steel Body, Stainless Steel Ball & Stem, PTFE Seats, Full Bore, Firesafe Design, 10" Anti-static Design, Lever Operated up to 8", 10" Gearbox Operated, Face to DIN 3202 F17



| Pressure / Temperature Specifications |                |
|---------------------------------------|----------------|
| Pressure                              | PN40 1" to 2"  |
|                                       | PN25 2½" to 5" |
|                                       | PN25 6" to 10" |
| Temperature                           | -20°C to 200°C |

| Material Specifications |                          |
|-------------------------|--------------------------|
| 1. Body                 | WCB Carbon Steel         |
| 2. Ball                 | AISI 304 Stainless Steel |
| 3. Stem                 | AISI 420 Stainless Steel |
| 4. Seats                | PTFE                     |
| 5. O-ring               | PTFE & Viton             |
| 6. Handle               | Galvanized Carbon Steel  |

| Dimensions |     |     |       |      |       |    |     |         |       |
|------------|-----|-----|-------|------|-------|----|-----|---------|-------|
| Size       | A   | ØB  | C     | ØD   | G     | b  | ØDk | ØdxN°   | Kg    |
| 1"         | 160 | 115 | 90.3  | 25   | 161   | 16 | 85  | 14 x 4  | 3.12  |
| 1¼"        | 180 | 140 | 108.3 | 31   | 237   | 16 | 100 | 18 x 4  | 5.07  |
| 1½"        | 200 | 150 | 116   | 40   | 276   | 16 | 110 | 18 x 4  | 6.81  |
| 2"         | 230 | 165 | 122.5 | 50   | 276   | 18 | 125 | 18 x 4  | 8.22  |
| 2½"        | 290 | 185 | 148.6 | 63.5 | 340   | 18 | 145 | 18 x 4  | 15.0  |
| 3"         | 310 | 200 | 160.6 | 78   | 340   | 20 | 160 | 18 x 8  | 21.7  |
| 4"         | 350 | 220 | 174.6 | 99   | 340   | 20 | 180 | 18 x 8  | 27.1  |
| 5"         | 400 | 250 | 219   | 125  | 545   | 22 | 210 | 18 x 8  | 37.9  |
| 6"         | 450 | 285 | 246   | 150  | 545   | 22 | 240 | 22 x 8  | 59.2  |
| 8"         | 550 | 340 | 348   | 200  | 1,000 | 24 | 295 | 22 x 12 | 102.9 |
| 10"        | 650 | 405 | 495   | 250  | 305   | 26 | 355 | 26 x 12 | 189.5 |

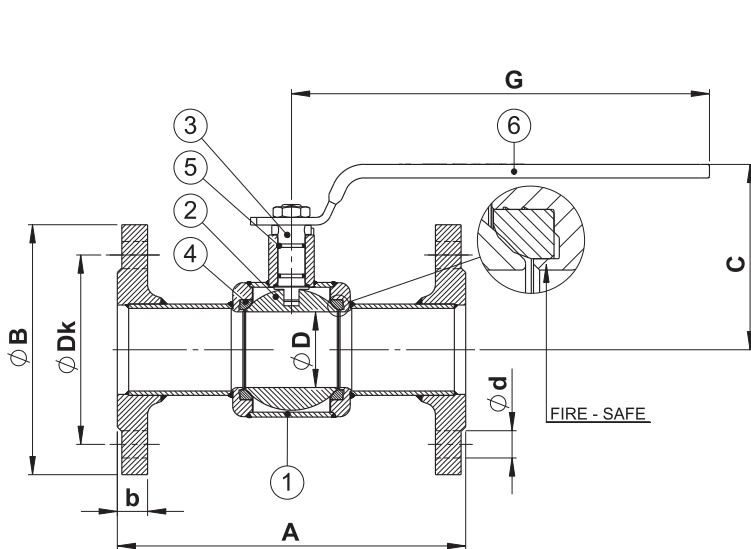

1" to 8"

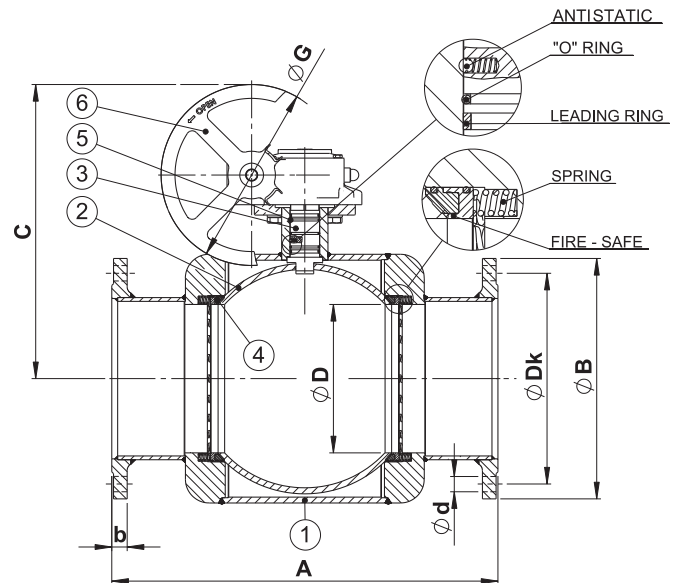

10"