

DISPENSERS ST 200 DC



EN. High flow rate portable dispenser unit. ST 200 dispenses diesel fuel at a rate of up to 200 l/min and controls the flow with great precision (+/- 1%) thanks to the oval-gear flow meter (on request).

ES. *nidad móvil de trasiego alta capacidad. ST 200 suministra gasoleo hasta 200 l/min y controla el flujo con precisión (+/-1%) con el cuentalímetro mecánico de engranajes ovalados (a petición).*

PT. Grupo distribuidor portátil de grande capacidade. O ST 200 distribui o combustível Diesel até 200 l/min e controla o fluxo com precisão (+/- 1%), graças ao conta-litros de engrenagens ovais (a pedido).

PERFORMANCE

- Flow rate up to 185 l/min
- Duty cycle 25 min ON / 12 min OFF
- Power supply 24 V DC

- Caudal hasta 185 l/min
- Ciclo de funcionamiento 25 min On / 12 min OFF
- Alimentación 24 V CC

- Caudal até 185 l/min
- Ciclo de trabalho 25 min ON / 12 min OFF
- Alimentação 24 V DC

DIMENSIONS

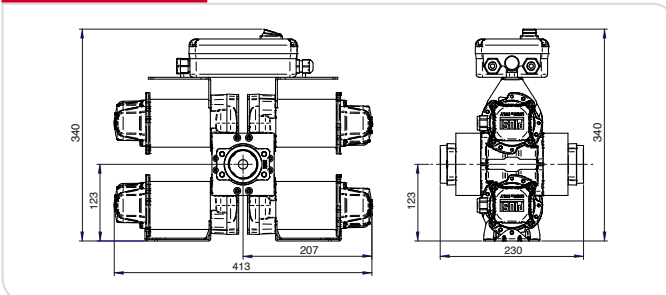

PRODUCTS' RANGE WEIGHT AND PACKAGING

Code	Weight		Packaging		
	kg	lbs	mm	inch	pcs/box
F00318000	18	40	480x370x265	18,9x14,6x10,4	1



Flow-rate

up to
185 l/min
(up to 48 gpm)



PIUSI[®]

DISPENSERS

PUMPS

METERS

NOZZLE METERS

NOZZLE

SPECIAL EQUIPMENTS

FLUID MONITORING

ACCESSORIES

FILTERING

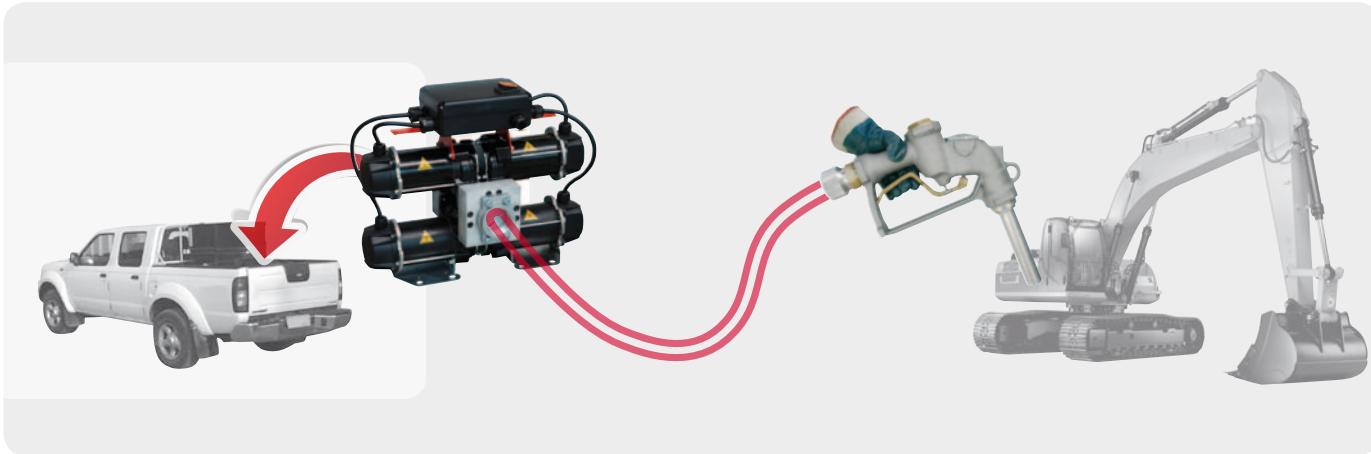
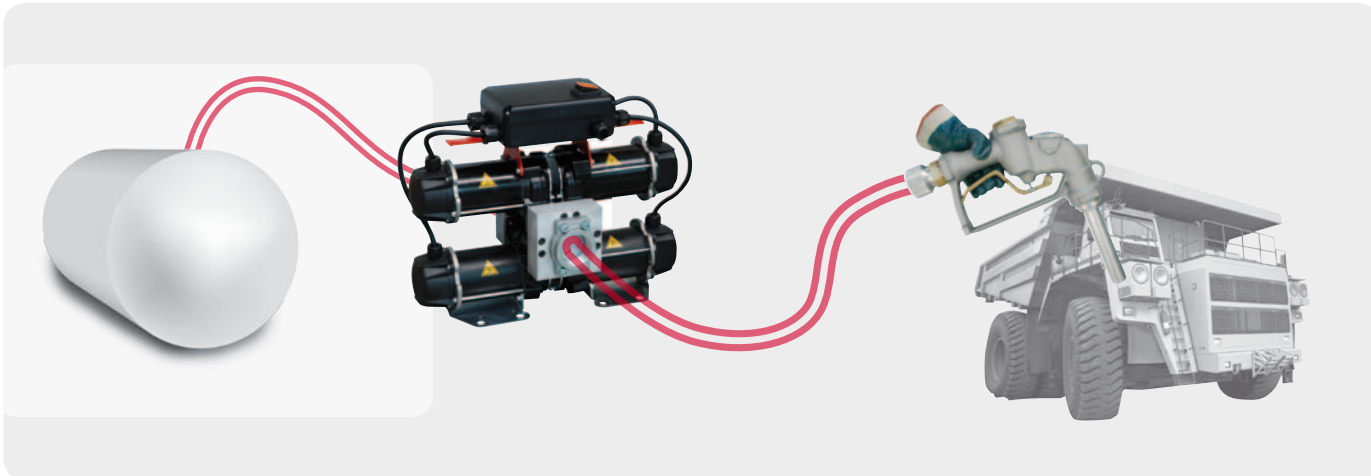

FEATURES

Electric cable included



Electric cables length
6 m with clamps

On/off switch included



ON REQUEST

Meter K700 M (optional)



Flow rate:
20 - 220 l/min
Accuracy: +/- 1%
Oval gear system
Code: FO0540000

Nozzle A280 (optional)



Flow rate 280 l/min
with swivel
Code: F13249000

PRODUCTS' RANGE TECHNICAL DATA

Code	Description	Fluids type	Flow-rate		Voltage			Duty cycle min.	Pump		Max pressure bar	Inlet BSP
			l/min	gpm	AC V./Hz DC Volt	Power Watt	Amp. max.		mod.	no.		
F00318000	ST 200 DC 24 V	D	155-185	42 - 48	24	1200	50	30	Bypass 3000	4	2	1" 1/2

Upon request it is available with different tension and 60 Hz frequency