



CAR FILLING



DISPENSERS



PUMPS



METERS



NOZZLE METERS



NOZZLES

DELPHIN PRO

FEATURES

- FULLY AUTOMATIC
- NO OPERATOR NEEDED
- 100% COMPATIBLE WITH ALL VEHICLES
- STURDY DESIGN
- EASY TO HANDLE
- FLOW RATE REGULATOR

The PIUSI Delphin Pro is the world leading mobile device dedicated to the AdBlue® car refilling. Its sturdy cart allows to be used in every condition.

PERFORMANCE

A

2-11 L/MIN

FLOW RATE

AC
VOLTAGE

POWER

2M

HOSE LENGTH



DELPHIN PRO



PACKAGING

CODE	WEIGHT		PACKAGING		
	KG	LBS	MM	INCH	PCS/BOX
FO010020A	37	81,5	770X1080X800	0,3X42X31,5	1
FO010021A	37	81,5	770X1080X800	0,3X42X31,5	1



FILTRATION



FLUID MONITORING



HOSE REELS



ACCESSORIES



MERCHANDISE



AIR



ANTIFREEZE



AdBlue®



BIODIESEL



DIESEL



FOOD



GASOLINE



GREASE



KEROSENE



OIL



WATER



WINDSCREEN

FUNCTIONING

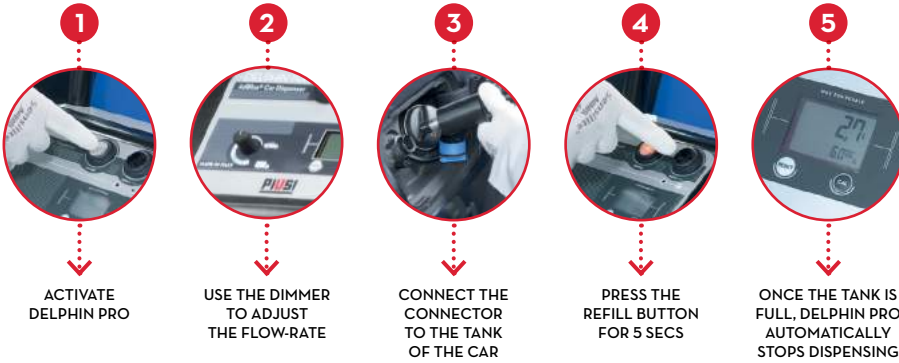

IN THE BOX

- DELPHIN PRO UNIT
- AF2/SEC CONNECTOR
- INSTRUCTION MANUAL

DETAILS



UNIVERSAL ISO CONNECTOR



SEC VERSION AVAILABLE



DIGITAL FLOW METER

DIMENSIONS

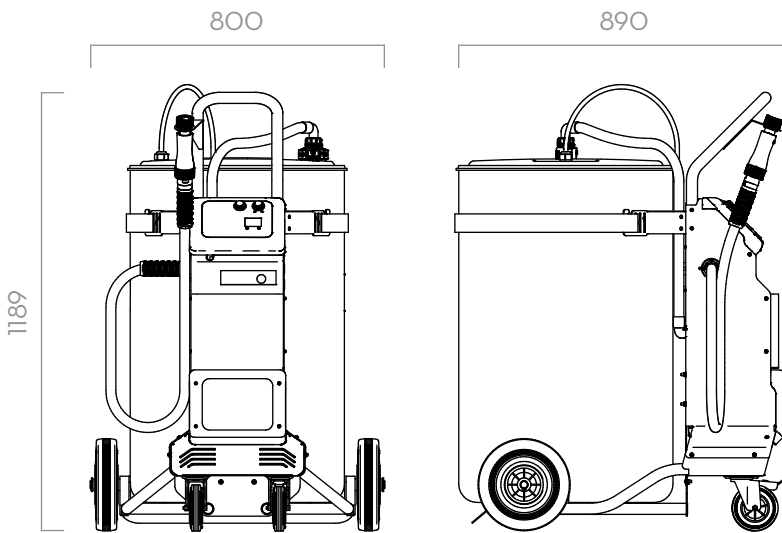

Dimensions expressed in millimeters

MATERIALS

- PUMP:
- BODY: POLIPROPYLENE
- DIAPHRAGM: POLIPROPYLENE

TECHNICAL DATA

CODE	DESCRIPTION	FLUIDS TYPE	FLOW-RATE		VOLTAGE			HOSE		ON/OFF
			L/MIN	GPM	AC V./HZ DC VOLT	POWER WATT	AMP. MAX.	LENGHT	Ø	SWITCH
FO010020A	DELPHIN PRO 230/50		2 - 11	0,5 - 2,9	230/50	400	1,95	2 M	3/4"	YES
FO010021A	DELPHIN PRO 230/50 SEC		2 - 11	0,5 - 2,9	230/50	400	1,95	2 M	3/4"	YES